

The high-speed, 6-axis MOTOMAN HP20D, HP20F robot offers superior performance in a variety of applications, such as handling, welding, machine tending, packaging, cutting and assembly, where small to medium sized parts are handled.

The compact HP20D, HP20F requires minimal installation space, and offers improved part accessibility and the widest work envelope in its class.

This all-round robots can be driven by the high-performance-controller DX100 as well as the compact-controller FS100.



Key benefits

- Increase productivity due to high speed motion
- Ideal for a variety of applications, multi-purpose robot
- Improved part accessibility
- A robust and rigid robot with increased inertia

MOTOMAN HP20D, HP20F

General purpose and handling

 **YASKAWA**

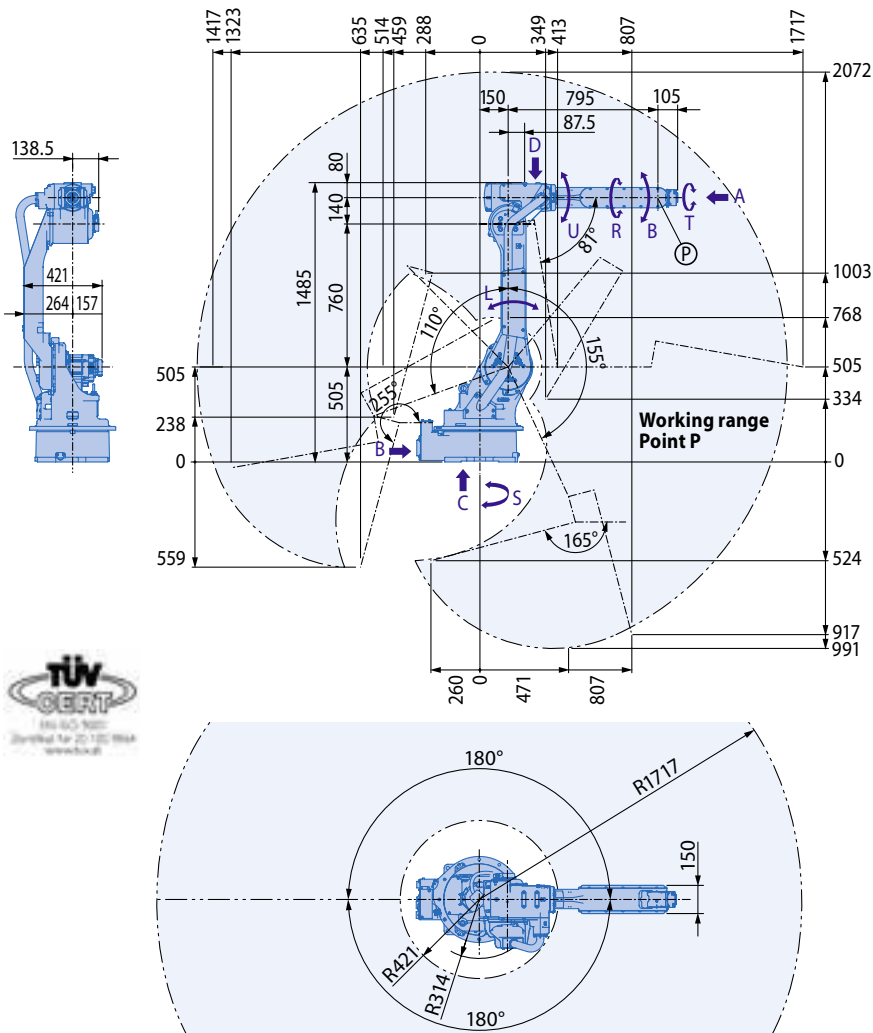

View A

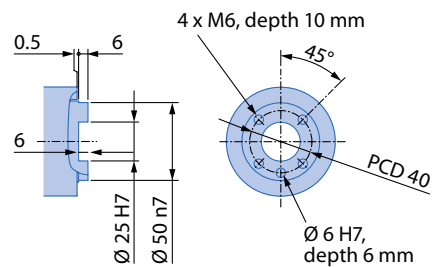

View B

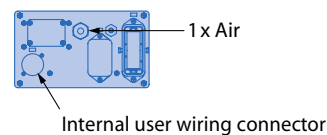

View C

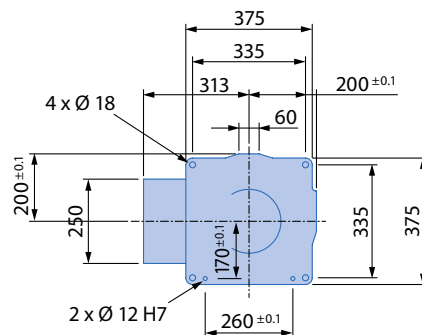

Mounting options: Floor, ceiling, wall

View D

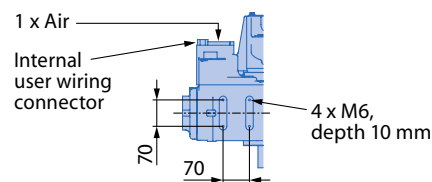

All dimensions in mm | Technical data may be subject to change without previous notice | Please request detailed drawings at robotics@yaskawa.eu.com - YR-HP0020D-B00 (DX100), YR-HP0020F-B00 (FX100), F-07-2012, A-No. 150273

Allowable wrist load

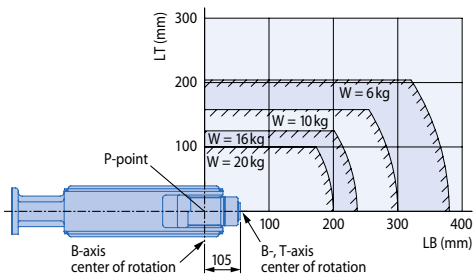

Allowable load on U-axis

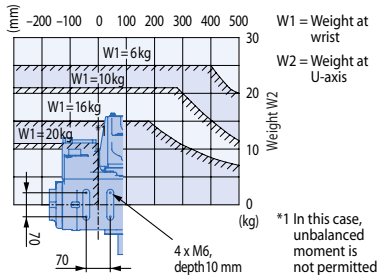

*1 In this case, unbalanced moment is not permitted

Specifications HP20D, HP20F

Axes	Maximum motion range [°]	Maximum speed [°/sec.]	Allowable moment [Nm]	Allowable moment of inertia [kg · m ²]	Controlled axes	6
S	±180	197	-	-	Max. payload [kg]	20
L	+155/-110	175	-	-	Repeat. pos. accuracy [mm]	±0.06
U	+255/-165	187	-	-	Max. working range [mm]	R = 1717
R	±200	400	39.2	1.05	Temperature [°C]	0 to +45
B	+230/-50	400	39.2	1.05	Humidity [%]	20 - 80
T	±360	600	19.6	0.75	Weight [kg]	268
					Power supply, average [KVA]	2



Headquarters Robotics Division

YASKAWA Europe GmbH
Yaskawastraße 1
D-85391 Allershausen
Tel. 0049-81 66-90-0
Fax 0049-81 66-90-103
robotics@yaskawa.eu.com
www.yaskawa.eu.com

YASKAWA Academy and sales office Frankfurt

YASKAWA Europe GmbH
Robotics Division
Hauptstraße 185
D-65760 Eschborn
Tel. 0049-61 96-777 25-0
Fax 0049-61 96-777 25-39
robotics@yaskawa.eu.com
www.yaskawa.eu.com